

# EL \*\*

Elemento logico DIN 24342  
Logical element DIN 24342

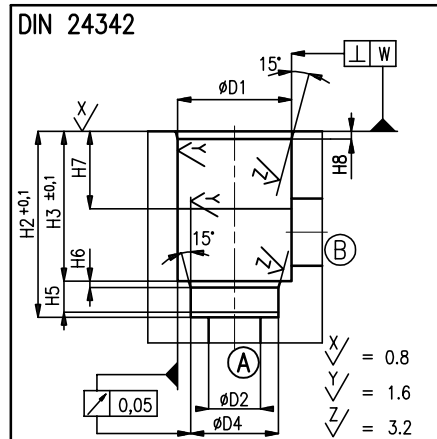
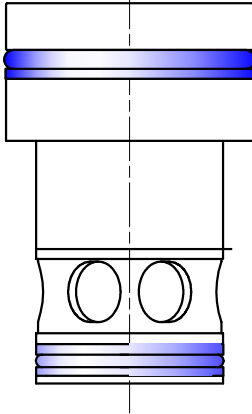

SIZE	NG16	NG25	NG32
$\phi D1H7$	32	45	60
$\phi D2$	16	25	32
$\phi D4H7$	25	34	45
H2	56	72	85
H3	43	58	70
H5	11	12	13
H6	2	2,5	2,5
H7	20	30	30
H8	2	2,5	2,5
W	0,05	0,05	0,1

- Fluido da utilizzare: olio idraulico a norme DIN 51524 con viscosità compresa tra 30 e 100 mm<sup>2</sup>/s (cSt) a 40° C
- Filtrazione richiesta del fluido impiegato 25  $\mu$
- Temperatura fluido idraulico: da -25° a +80° C

- Fluid to be used: hydraulic oil to DIN 51524 standards with a viscosity between 30 and 100 mm<sup>2</sup>/s (cSt) to 40° C
- The fluid filtration requested is 25  $\mu$
- Temperature hydraulic fluid: -25° to +80° C

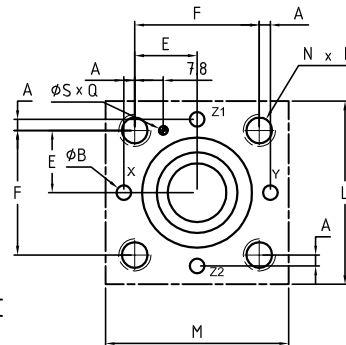

SIZE	NG16	NG25	NG32
M	80	85	85
L	65	85	85
A	2	4	6
E	23	29	35
F	46	58	70
S	4	6	6
Q	7	8	8
N	M8	M12	M16
P	22	30	38
B	4	6	8

## Esempio di ordinazione - ordering code

